

INSTALLATION INSTRUCTIONS

MULTI-RACK ADJUSTABLE TRUNK LUGGAGE RACK, GLOSS BLACK

7149

THANK YOU FOR CHOOSING KURYAKYN!

Protect yourself and others from possible injury and property damage or loss. Pay close attention to all instructions, warnings, cautions, and notices regarding the installation, use, and care of this product.

WARNING THIS INDICATION ALERTS YOU TO THE FACT THAT IGNORING THE CONTENTS DESCRIBED HEREIN CAN RESULT IN POTENTIAL DEATH OR SERIOUS INJURY.

CAUTION THIS INDICATION ALERTS YOU TO THE FACT THAT IGNORING THE CONTENTS DESCRIBED HEREIN CAN RESULT IN MINOR OR MODERATE POTENTIAL INJURY.

NOTICE THIS INDICATION ALERTS YOU TO THE FACT THAT IGNORING THE CONTENTS DESCRIBED HEREIN MAY NEGATIVELY AFFECT PRODUCT PERFORMANCE AND FUNCTIONALITY OR DAMAGE THE PRODUCT ITSELF OR THE PRODUCT TO WHICH IT IS BEING ATTACHED.

ENSURE THAT THE FOLLOWING PARTS HAVE BEEN INCLUDED IN THE KIT:

- | | |
|---------------------------------|--|
| 1 Multi-Rack | 1 Hardware Kit, containing: |
| 1 Mounting Leg Kit, containing: | 4 #10-24 X 1-1/8" Socket Head Cap Screws |
| 2 Short Mounting Legs | 8 Rubber Washers |
| 2 Medium Mounting Legs | 4 Wide Flat Washers |
| 2 Tall Mounting Legs | 4 #10-24 X 7/8" Socket Head Cap Screws |
| 1 Clamp Kit, containing: | 1 Foot Kit, containing: |
| 4 Clamp Assemblies | 4 Round Rack Foot Bases |

YOU WILL ALSO NEED:

Set of Hex Wrenches, Drill and Drill Bit Set, Center Punch, Masking Tape, Non-Permanent Marker

PICTURES SHOWN ARE OF THE CHROME PARTS. INSTALLATION OF THE BLACK PARTS WILL BE THE SAME.

NOTICE THESE INSTALLATION INSTRUCTIONS CONTAIN IMPORTANT INFORMATION. ENSURE THE END USER RECEIVES THIS COPY AND IS AWARE OF ITS IMPORTANCE FOR FUTURE USE.

NOTICE THIS PRODUCT WAS DESIGNED TO FIT MANY DIFFERENT MODELS OF TRUNK LID. IT IS UP TO THE INSTALLER TO DETERMINE THE BEST INSTALLATION. THE FOLLOWING ARE GUIDELINES TO ASSIST IN THE INSTALLATION OF THE MULTI-RACK.

STEP 1 Read and understand all steps in the instructions before starting the installation. Park the motorcycle on a hard, level surface and turn off the ignition. Let motorcycle cool.

STEP 2 Refer to PIC 2. Determine the best mounting location of the Multi-Rack by holding it above the trunk lid.

NOTICE EACH MOUNTING FOOT REQUIRES AT LEAST A 1 1/8 INCH DIAMETER FLAT AREA TO MOUNT. DO NOT MOUNT ALL FOUR FEET ON THE CENTER TWO BARS.

IT IS HIGHLY RECOMMENDED THAT THE CLAMP/STAND ASSEMBLIES BE POSITIONED AS FAR APART FRONT TO BACK AS POSSIBLE.

DO NOT ATTACH THE CLAMP ASSEMBLIES ON A BEND IN THE RACK BARS.

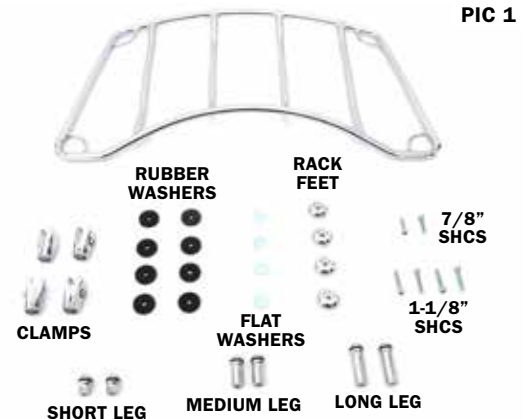

INSTALLATION INSTRUCTIONS

MULTI-RACK ADJUSTABLE TRUNK LUGGAGE RACK, GLOSS BLACK

7149

-CONTINUED-

STEP 3 Refer to PIC 3. Mark the locations for the clamp on the rack with masking tape or non-permanent marker. Mark the locations of the feet on the lid with masking tape.

STEP 4 Determine the best combination of mounting legs.

NOTICE REFER TO PIC 4. SHORT, MEDIUM AND TALL MOUNTING LEGS HAVE BEEN INCLUDED TO ACCOMMODATE DIFFERENT SHAPED TRUNK LIDS.

IT IS RECOMMENDED TO MOUNT THE RACK AS HORIZONTALLY AS POSSIBLE. SELECT THE COMBINATION OF MOUNTING LEGS THAT WILL ALLOW FOR THE MOST HORIZONTAL POSITION.

STEP 5 To allow for adjustment, loosely assemble the clamp/stand assemblies at the marks on the rack. Loosen the socket head cap screw in the clamp assemblies until they are able to be slipped over the rack bars. Snug the fasteners to allow adjustment of the clamps on the rack bars.

NOTICE REFER TO PIC 5. TIGHTENING THE SOCKET HEAD CAP SCREW IN THE CLAMP ASSEMBLY WILL SIMULTANEOUSLY SECURE THE CLAMP TO THE BAR AND THE MOUNTING LEG. ENSURE THAT THE MOUNTING LEGS REMAIN IN THE CLAMPS WHEN ATTACHING TO THE RACK BARS.

ENSURE THAT THE O-RINGS REMAIN INSTALLED ON THE MOUNTING LEG BALL END.

STEP 6 Refer to PIC 6. Gently rest the rack on top of the tape marks on the lid to confirm the fitment of the mounting locations. Make any necessary adjustments to the clamp/stand assemblies. Slightly loosen the clamps to avoid scratching the rack bars. See NOTICE on the next page.

NOTICE REFER TO PIC 8. THE MOUNTING LEGS SHOULD BE SECURED PERPENDICULARLY TO THE TRUNK LID SURFACE.

STEP 7 Ensure that the rack is in the correct position, the legs are adjusted to contact the lid perpendicularly and the spacing between the clamp assemblies is sufficient. With a non-permanent marker, trace around the mounting legs on the masking tape.

NOTICE MEASURE TWICE - DRILL ONCE. DOUBLE CHECK ALL REFERENCE MARKS ON THE TRUNK LID BEFORE DRILLING. KURYAKYN WILL NOT BE RESPONSIBLE FOR INCIDENTAL OR CONSEQUENTIAL DAMAGES RESULTING FROM THIS INSTALLATION.

ENSURE THAT THERE IS SUFFICIENT CLEARANCE AND THAT THERE ARE NO OBSTRUCTIONS ON THE UNDERSIDE OF THE TRUNK LID BEFORE DRILLING ANY HOLES.

STEP 8 Double check to be certain the rack is centered in the position you desire. Carefully drill a 1/4" hole at the center of the marked locations. (Hint: You may want to drill a smaller diameter pilot hole first. This will lessen the chance of the drill "walking" and harming the finish. While drilling the rear holes, try to match the angle of the rear mounting legs.)

STEP 9 Refer to PIC 8. Loosely attach the Multi-Rack to the trunk lid. Insert the #10-24 x 1 1/8" Socket Head Cap Screws through the wide flat washers and rubber washers, through the trunk lid, 2nd rubber washers, Round Rack Foot Bases and into the mounting legs.



PIC 3



PIC 4

PIC 5



PIC 6

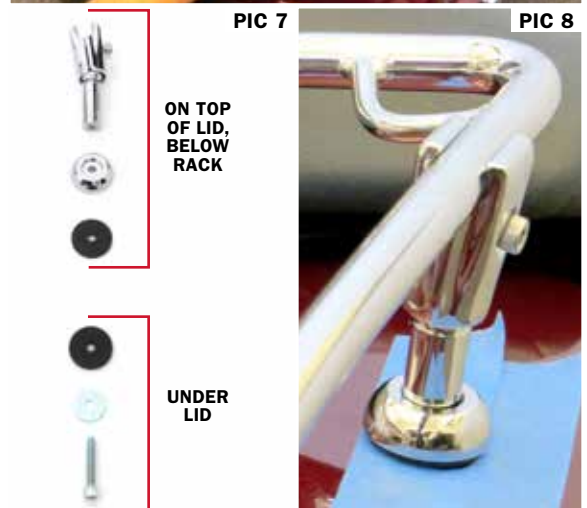

PIC 7

PIC 8

INSTALLATION INSTRUCTIONS

MULTI-RACK ADJUSTABLE TRUNK LUGGAGE RACK, GLOSS BLACK

7149

-CONTINUED-

FINAL

NOTICE

THE TWO 10-24 X 7/8" SOCKET HEAD CAP SCREWS HAVE BEEN INCLUDED FOR USE WITH THE SHORT MOUNTING LEGS. IN SOME INSTANCES THE MOUNTING LEGS MAY SPIN WHILE TIGHTENING THE 10-24 FASTENERS. IF THIS OCCURS, LOOSEN THE 10-24 SOCKET HEAD CAP SCREWS IN THE CLAMPS UNTIL YOU CAN REMOVE THE RACK AND THE CLAMPS. INSERT A FLAT BLADE SCREWDRIVER IN THE SLOT IN THE TOP OF THE MOUNTING LEG TO PREVENT THE LEG FROM SPINNING WHILE THE SCREW IS TIGHTENED. REPLACE CLAMPS AND RACK AND TIGHTEN ALL HARDWARE.

STEP 10

If you are satisfied with the location and position of the Multi-Rack, tighten all hardware securely.

WARNING

THE LUGGAGE RACK HAS A 5 POUND LOAD CAPACITY. IT IS UP TO THE RIDER TO USE THE RACK IN A SAFE AND PROPER MANNER. OVERLOADING OR USING THE RACK IMPROPERLY MAY RESULT IN LOSS OF CONTROL, WHICH MAY RESULT IN SEVERE DAMAGE TO THE MOTORCYCLE AND/OR SERIOUS INJURY OR DEATH TO THE RIDER AND/OR THEIR PASSENGER. KURYAKYN IS NOT RESPONSIBLE FOR ANY DAMAGE, LOSS, OR INJURY CAUSED BY EXCEEDING THE LOAD CAPACITY.

WARNING

NEVER EXCEED THE MANUFACTURER'S RECOMMENDED GROSS VEHICLE WEIGHT. EXCESS LOADING ON THE MOTORCYCLE COULD CAUSE DAMAGE, LOSS OR INJURY. KURYAKYN IS NOT RESPONSIBLE FOR ANY DAMAGE, LOSS, OR INJURY CAUSED BY EXCEEDING THE GROSS VEHICLE WEIGHT LIMITS.

NOTICE

IT IS THE INSTALLER'S RESPONSIBILITY TO ENSURE THAT ALL OF THE FASTENERS (INCLUDING PRE-ASSEMBLED) ARE TIGHTENED BEFORE OPERATION OF THE MOTORCYCLE. KURYAKYN WILL NOT PROVIDE WARRANTY COVERAGE ON PRODUCTS OR COMPONENTS LOST DUE TO IMPROPER INSTALLATION OR LACK OF MAINTENANCE. PERIODIC INSPECTION AND MAINTENANCE ARE REQUIRED ON ALL FASTENERS.



INSTALLATION INSTRUCTIONS

MULTI-RACK ADJUSTABLE TRUNK LUGGAGE RACK, GLOSS BLACK

7149

-CONTINUED-

LIMITED WARRANTY

Kuryakyn warrants that any Kuryakyn products sold hereunder, shall be free of defects in materials & workmanship for a period of one (1) year from the date of purchase by the consumer excepting the following provisions:

1. Kuryakyn shall have no obligation in the event the customer is unable to provide a receipt showing the date the customer purchased the product(s).
2. The product must be properly installed, maintained & operated under normal conditions.
3. Kuryakyn shall not be liable for any consequential & incidental damages, including labor & paint, resulting from failure of a Kuryakyn product, failure to deliver, delay in delivery, delivery in nonconforming condition, or for any breach of contract or duty between Kuryakyn & a customer.
4. Kuryakyn products are often intended for use in specific applications. Kuryakyn makes no warranty if a Kuryakyn product is used in applications other than intended.
5. Kuryakyn electrical products are warranted for one (1) year from the date of purchase by the consumer. L.E.D.'s contained in components of Kuryakyn products will be warranted for defects in materials & workmanship for 3 years from the date of purchase whereas all other components shall be warranted for one (1) year.
6. All warranty claims must be directed to the place of purchase. Merchandise sold through internet auction sites or any other unauthorized reseller shall not carry a Kuryakyn warranty. If unsure, please contact the place of purchase to verify they are an authorized Kuryakyn reseller.

RETURN POLICY

Merchandise determined to be defective may be returned up to one year from the date of purchase. Returns must be processed through original seller. Returned merchandise for any other reason other than warranty claims must be in like new condition & subject to a 20% restocking fee. All returns are subject to inspection for determination of full or partial credit. Any returned part that shows evidence of being used or installed contrary to manufacturer's instructions, &/or subjected to improper handling, packaging or return shipping by the customer, will not be eligible for exchange, refund or warranty consideration. All returned electrical items will be inspected & tested. If electrical item is deemed functional, no credit will be issued & item will be returned. All sales are final on discontinued or closeout merchandise.

©2015 KURYAKYN HOLDINGS, LLC ALL RIGHTS RESERVED

KURYAKYN, KURYAKYN K logo and the marks appearing on this instruction sheet are registered and common law trademarks of Kuryakyn Holdings except noted third-party trademarks. A full listing of trademarks and trademark registrations owned by Kuryakyn Holdings can be found at www.kuryakyn.com/legal-notice.

Emissions Notice: The California Air Resources Board (CARB) does not permit the use of aftermarket emission-related parts(s) that alter the performance of OEM emission-related devices unless CARB has issued an Executive Order, other than on racing vehicles on closed courses. Check your local laws and manufacturer's information.

Listed Manufacturers and product model names are for reference only. All product and company names are trademarks or registered trademarks of their respective holders. Use of them does not imply any affiliation with or endorsement by them. All specifications are subject to change without notice.

For additional information on third-party product and company names, please consult our Web page at www.kuryakyn.com/legal-notice