



# INSTALLATION GUIDE

PARTS: 0414-0530, 0414-0531, 0414-0532, 0414-0541, 0414-0542, 0414-0543

## PRELOAD SETTING CHART FOR AXEO

OVERALL RIDER(S) WEIGHT IN LBS. (INCLUDING LUGGAGE)	NUMBER OF TURNS
100-200	0
200-300	1
300-400	2
400-500+	3

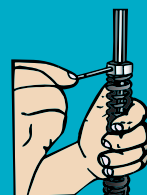

## OIL VOLUME & STANCHION TUBE CHART FOR AXEO23/AXEO21

AXEO 23/21" PART #	TUBE SIZE	FITMENT	LENGTH	OZ OF OIL TO ADD	STANCHION TUBE #
0414-0530	41 MM	2009-13 FLH	STD	4.5 OZ	45972-09
0414-0531	49 MM	2014-16 FLH	STD	13.5 OZ	45500113
0414-0532	49 MM	2017+ FLH	STD	14 OZ	45500341
0414-0541	41 MM	2009-13 FLH	STD	4.5 OZ	45972-09
0414-0542	49 MM	2014-16 FLH	STD	13.5 OZ	45500113
0414-0543	49 MM	2017+ FLH	STD	13.5 OZ	45500341



### AXEO23 FITMENT:

#### 0414-0530:

09-13 H-D FLH  
TOURING MODELS (41 MM)

#### 0414-0531:

14-16 H-D FLH  
TOURING MODELS (49 MM)

#### 0414-0532:

17-19 H-D FLH  
TOURING MODELS (49 MM)

### AXEO21 FITMENT:

#### 0414-0541:

09-13 H-D FLH  
TOURING MODELS (41 MM)

#### 0414-0542:

14-16 H-D FLH  
TOURING MODELS (49 MM)

#### 0414-0543:

17-19 H-D FLH  
TOURING MODELS (49 MM)



## WARRANTY

All Legend Suspensions™ parts are guaranteed to the original purchaser to be free of manufacturing defects and workmanship. Merchandise that fails to conform to these conditions will be repaired or replaced at Legend Suspensions™ option if the parts are returned to us by the purchaser. Warranty coverage is limited lifetime.

In the event warranty service is required, the original purchaser must call or e-mail Legend Suspensions™ immediately with the problem. Some problems can be rectified by a telephone call and need no further course of action.

A part that is suspect of being defective must not be replaced by a Dealer without prior authorization from Legend Suspensions™. If it is deemed necessary for Legend Suspensions™ to make an evaluation to determine whether the part was defective, a return authorization number must be obtained from Legend Suspensions™. The parts must be packaged properly so as to not cause further damage and be returned prepaid to Legend Suspensions™ with a copy of the original invoice of purchase. If after an evaluation has been made by Legend Suspensions™ and the part was found to be defective, repair will be made at Legend Suspensions™ discretion.

### ADDITIONAL WARRANTY PROVISIONS

- Legend Suspensions™ shall have no obligation in the event a Legend Suspension™ part is modified by any other person or organization.
- Legend Suspensions™ shall have no obligation if a Legend Suspensions™ part becomes defective in whole or in part as a result of improper installation, improper maintenance, improper use, abnormal operation, or any other misuse or mistreatment of the part.
- Legend Suspensions™ shall not be liable for any consequential or incidental damages resulting from the failure of a Legend Suspensions™ part, the breach of any warranties, the failure to deliver, delay in delivery in non-conforming condition, or for any other breach of contract of duty between Legend Suspensions™ and a customer.
- Legend Suspensions™ shall have no warranty or liability obligation if a Legend Suspensions™ part is used in any other application. Vehicles used in competition or off road are exempt from all warranties.
- All warranty items will require the original purchase invoice.
- Legend Suspensions™ shall have no warranty or liability obligation to cover workshop labor charges incurred to install or remove suspension system or individual components.
- Electrical components have a one year manufacturers warranty from the original invoice date or installation.
- Limited lifetime warranty is further defined as the lifetime of specific product line.
- Customer is liable for shipping charges to and from Legend Suspensions™ for warranty repairs or replacement parts.

WARNING: Legend Suspensions™ assumes no responsibility for damage or injuries which may result from the use or installation of its products, whether or not properly installed or used. Installing a Legend Suspensions system may decrease initial ground clearance when in lowered position. The motorcycle will be lower to the ground and care should be taken to avoid bottoming out, especially over bumps or in turns. To maintain proper balanced geometry, we recommend riding in the stock height position.

All parts sold or manufactured by Legend Suspensions™ are warranted against all manufacture defects or workmanship defects. Should a product we manufacture be defective, it must be returned to Legend Suspensions™. All returns must be authorized in advance with RA#. Freight must be prepaid by customer. If our product is found to be defective, it will be repaired free of charge or exchanged at Legend Suspensions™ discretion. Repairs or exchanges will not be issued if merchandise has been damaged, abused or modified. Any disagreement which may arise out of this agreement shall be submitted to arbitration and shall be enforceable under the laws of the State of South Dakota. Judgment on the award shall be entered into by the said court, and the decision of the arbitrator shall be a condition precedent to legal rights. The parties shall submit disputed matters under the Rules of the American Arbitration Association and the losing party shall pay both parties' attorneys' fees and costs.





**DO NOT TAMPER WITH THE SCHRADER VALVE ON TOP OF CAP!**

**WARNING**



IT'S EXTREMELY IMPORTANT THAT YOU MEASURE AND VERIFY THE DISTANCE BETWEEN THE TOP OF FRONT FENDER AND THE LOWEST PART OF THE TRIPLE CAMP/BRAKET ASSEMBLY TO KNOW WHAT TRAVEL LIMIT YOU NEED. FOLLOW THESE PRE-ASSEMBLY STEPS:

1. INSTALL TLC COLLARS INTO THE LOWER FORK LEGS AND REASSEMBLE UPPER AND LOWER TUBES
  2. DO NOT INSTALL CARTRIDGES AT THIS TIME
  3. INSERT FORK LEGS INTO TRIPLE CLAMPS, SET TUBE HEIGHTS AND TIGHTEN PINCH BOLTS
  4. INSTALL FRONT FENDER
  5. COMPRESS FORKS BY HAND SLOWLY UNTIL THE FORKS BOTTOM OUT AGAINST THE TRAVEL LIMITERS
  6. VERIFY FENDER TO CLEAR ALL FRONT END COMPONENTS (MAY NEED TO SLIGHTLY ADJUST TUBE HEIGHTS IN TRIPLE CLAMPS - 49 MM ONLY)
  7. ONCE ADEQUATE CLEARANCE IS CONFIRMED THEN THE CARTRIDGES CAN BE INSTALLED IN THE FORK LEGS
- \* AXEO 21/2.3" KITS MUST BE USED IN HD-OEM STANCHION TUBE LENGTHS. SEE CHART ON BACK COVER  
 \* AXEO 21/2.3" KITS CAN BE USED WITH ARLEN NESS "HOT LEGS" OR HD-OEM LOWER SLIDERS

**ATTENTION AXEO2.3 ONLY :** INSTALLING THE AXEO2.3 REQUIRES THE SEPARATE PURCHASE OF ARLEN NESS 7&7 RAKED TREES FOR FLT MODELS:  
 ARLEN NESS #: 20-389/DRA6 #: 0408-0317 FOR 2014+ MODELS  
 ARLEN NESS #: 20-378/DRA6 #: 0408-0316 FOR 97-2013 MODELS



**FIGURE F**



# 5

**STEP FIVE: REASSEMBLE AND INSTALL**

- A. SECURE LOWER SLIDER IN TUBE VISE AND DROP THE TLC COLLAR IN WITH CUP FACING UP. **FIGURE E**
- B. PRE-LUBE AND INSTALL THE NEW BUSHING ON STANCHION TUBE AND PRE-LUBE BUSHING AND TUBE WITH FORK OIL.
- C. PRE-LUBE THE LOWER SLIDER AND INSERT THE STANCHION TUBE INTO THE LOWER SLIDER...CAREFULLY, LOWER IT ALL THE WAY DOWN.
- D. PRE-LUBE AND INSTALL THE LOWER SLIDER BUSHING (REQUIRES INSTALLING TOOL).
- E. INSTALL THE STEEL SPACER AND RUBBER SEAL (REQUIRES INSTALLING TOOL).
- F. INSTALL RETAINING RING.
- G. DROP PROVIDED TOP OUT SPRING INTO TOP OF TUBE. **FIGURE F**
- H. LOWER THE LEGEND AXEO CARTRIDGE INTO THE TUBE, MAKING SURE ITS' LOWER ROD INSERTS INTO THE TLC COLLAR ALIGNMENT CUP.
- I. RE-INSTALL THE LOWER ALLEN BOLT AND COPPER SEALING WASHER WITH A SMALL AMOUNT OF LOCTITE ON THE THREADS.
- J. HOLD CARTRIDGE BY HAND WHILE TIGHTENING THE LOWER ALLEN BOLT TO 15 FT. LBS. FOR A 8MM BOLT (41 MM) AND 28 FT. LBS. FOR A 14MM BOLT (49MM).

**FIGURE E (TLC - TRAVEL LIMIT COLLAR)**

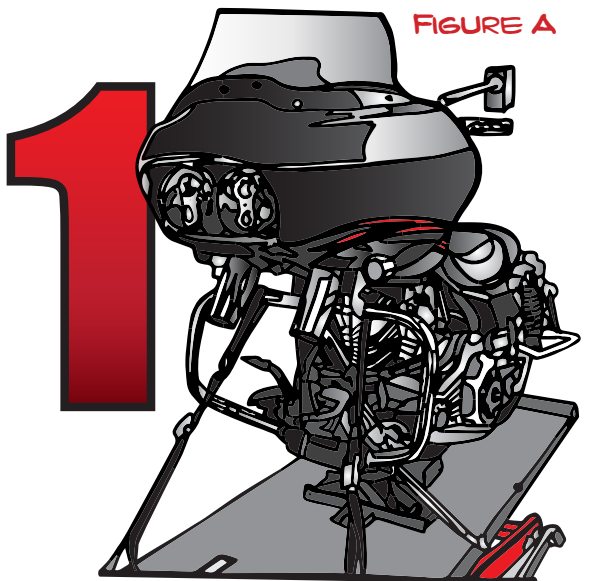
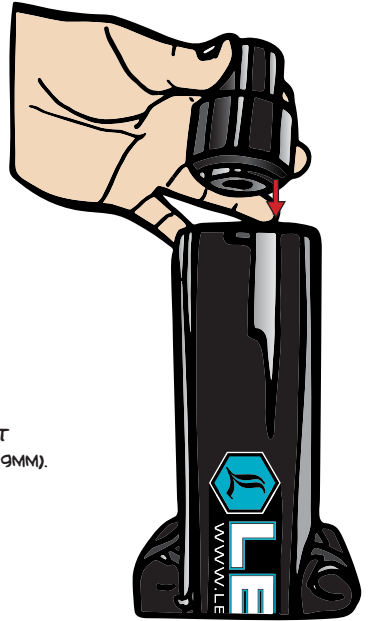

**FIGURE A**

**STEP ONE: FORK REMOVAL**

- A. PROPERLY SUPPORT YOUR MOTORCYCLE THEN REMOVE STOCK FORKS FROM MOTORCYCLE, CONSULT WITH AN EXPERIENCED TECHNICIAN BEFORE REMOVAL IF NEEDED. **FIGURE A.**

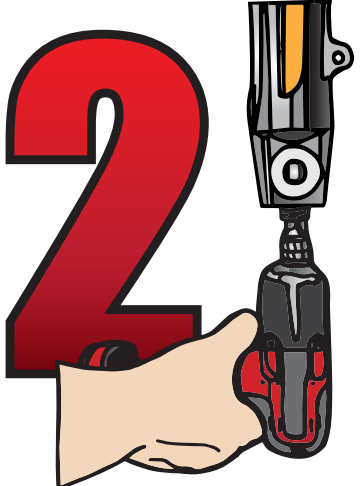

**FIGURE B**

**STEP TWO: DISASSEMBLY**

- A. SECURE FORKS IN A FORK VICE OR SOFT CLAMP TO ELIMINATE SCRATCHING ON STANCHIONS (UPPER TUBES).
- B. USE AN IMPACT WRENCH TO REMOVE THE LOWER ALLEN BOLT. **FIGURE B.**
- C. LET THE OIL DRAIN OUT AND PUMP FORK SEVERAL TIMES TO REMOVE ALL ORIGINAL OIL.
- D. WITH FORK STILL IN VICE, REMOVE TOP FORK CAP. **WARNING: BE EXTREMELY CAREFUL WHEN REMOVING THE CAP, IT IS UNDER HIGH SPRING PRESSURE AND MAY CAUSE INJURY. FIGURE C.**
- E. DUMP ALL STOCK COMPONENTS OUT OF FORKS.
- F. RETURN THE ASSEMBLY TO THE VISE, CLAMPING ON THE LOWER SLIDER AND REMOVE RETAINING RING FROM TOP OF LOWER SLIDER, THEN REMOVE THE STANCHION TUBE WITH BUSHING/SPACER/SEAL.
- G. REMOVE OLD BUSHINGS AND SEALS FROM TUBE BEFORE CLEANING.
- H. IT'S HIGHLY RECOMMENDED TO REPLACE TUBE BUSHINGS AND LOWER SLIDER BUSHINGS AND SEALS AND NOT RE-USE THE OLD ONES.

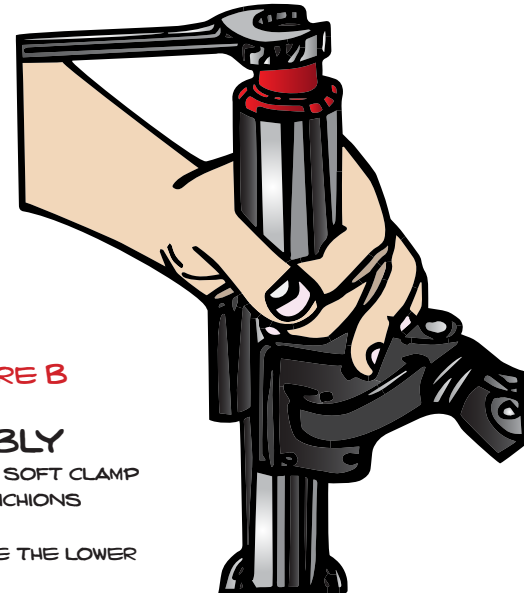
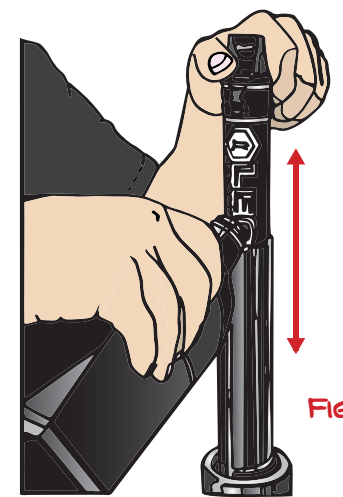

**FIGURE C**

# 6

**STEP SIX: ADDING OIL AND BLEEDING**

- A. REFER TO THE OIL VOLUME CHART ON THE BACK COVER OF THIS INSTALL GUIDE FOR THE AMOUNT OF OIL TO ADD PER FORK. **IMPORTANT: THE AMOUNT OF OIL ADDED INSURES THE HYDRAULIC BUMP STOP WILL FUNCTION CORRECTLY.**
- B. POUR OIL IN TOP OF TUBE, YOU WILL NEED TO PUMP THE STANCHION A FEW TIMES WHILE DOING THIS TO LET OIL DRAIN DOWN INTO TUBE. **FIGURE G.**
- C. ONCE RECOMMENDED AMOUNT OF OIL HAS BEEN ADDED, PUMP THE STANCHION UP AND DOWN SEVERAL TIMES TO MAKE SURE YOU HAVE THE OIL INTO THE LOWER PART OF THE SLIDER.
- D. AFTER BLEEDING THE FORKS, SLIDE THE STANCHION UP AND THREAD ONTO THE FORK CAP.
- E. TIGHTEN THE FORK CAP TO 25 FT. LBS.



**FIGURE G**

# 3

**STEP THREE: CLEAN FORKS**

- A. CLEAN ALL USED FOR OIL FROM STANCHION TUBES AND LOWER SLIDERS.
- B. USE SOLVENT AND A LONG SOFT BORE BRUSH TO REMOVE METALLIC OIL FILM.
- C. USE SUSPENSIONS CLEANER TO REMOVE ANY OILY RESIDUE.
- D. DRY ALL PARTS WITH COMPRESSED AIR.

# 4

**STEP FOUR: SET PRELOAD FOR LEGEND CARTRIDGE**

- A. REFER TO THE PRELOAD SETTING CHART (BASED ON RIDER AND GEAR WEIGHT) ON THE BACK COVER OF THIS INSTALL GUIDE.
- B. USE AN ALLEN WRENCH TO LOOSEN THE SET SCREW ON THE PRELOAD ADJUSTER. **FIGURE D.**
- C. USE THE RECOMMENDED NUMBER OF TURNS FROM THE CHART AND THREAD YOUR PRELOAD ADJUSTER TOWARDS THE SPRING. **PRELOAD ADJUSTER IS SET AT ZERO, ONE FULL TURN IS INDICATED BY SET SCREW ALIGNING WITH "FLAT."**
- D. **IMPORTANT: LINE THE SET SCREW UP WITH THE "FLAT" THAT IS MACHINED IN THE SHAFT, AND RE-TIGHTEN THE SET SCREW WHEN COMPLETE.**

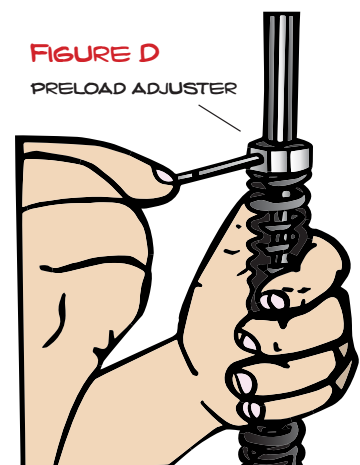

**FIGURE D**  
PRELOAD ADJUSTER

# 7

**STEP SEVEN: INSTALL FORKS**

- A. ONCE FORKS ARE COMPLETELY ASSEMBLED RE-INSTALL THEM ONTO YOUR MOTORCYCLE FOLLOW THE MANUFACTURERS' TORQUE SPECS FOR SAFETY.