



CIRO ADJUSTABLE HIGHWAY PEG MOUNTS

Parts Included:

1	Right Arm	1	Hardware Kit Including:
1	Left Arm	2	3/8"-16 x 1-3/8" SHCS
1	Right Mount	2	3/8"-24 x 7/8" SHCS
1	Left Mount	4	3/8" High Collar Split Lock Washers
2	Arms	4	3/8" Flat Washers
2	Clevis	2	3/8" Split Lock Washers
		4	3/8"-24 x 1-1/8" SHCS
		2	D Springs
		2	4-40 x 3/8" BSHCS
		2	Tab Springs

Installation Instructions:

1. Park on a level surface and shut off the motorcycle. Ensure that the engine has had time to cool before installation.

2. Angle right floorboard up. Use a 5/16" hex wrench and 9/16" box wrench to remove original 3/8"-16 x 2-1/2" SHCS and 3/8" nut. Set aside to reuse. **Note:** 2017 and newer models do not have 3/8" nut, motorcycle frame has a threaded hole.

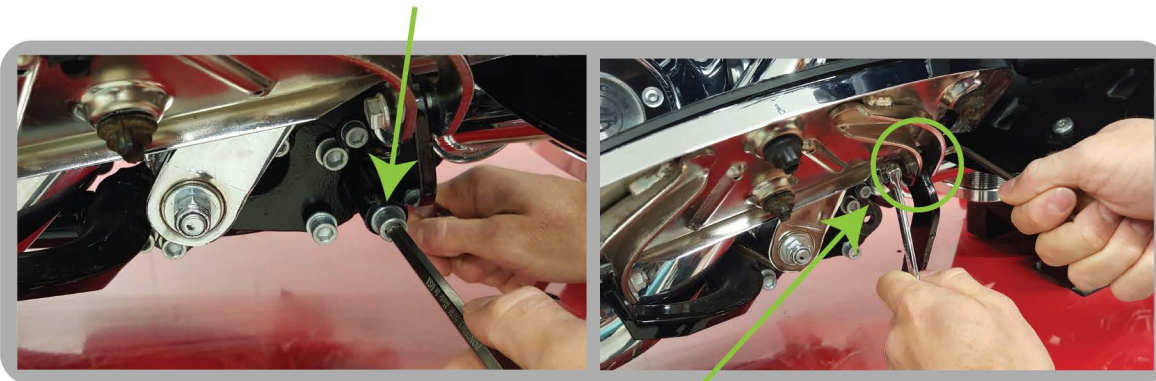

3. Using a 3/16" hex wrench and 7/16" box wrench, remove floorboard pivot pin. Remove floorboard bracket. Set aside pin and nut for reuse.

4. Use a 5/16" hex wrench to remove lower frame bracket SHCS. Set aside, this will not be reused.

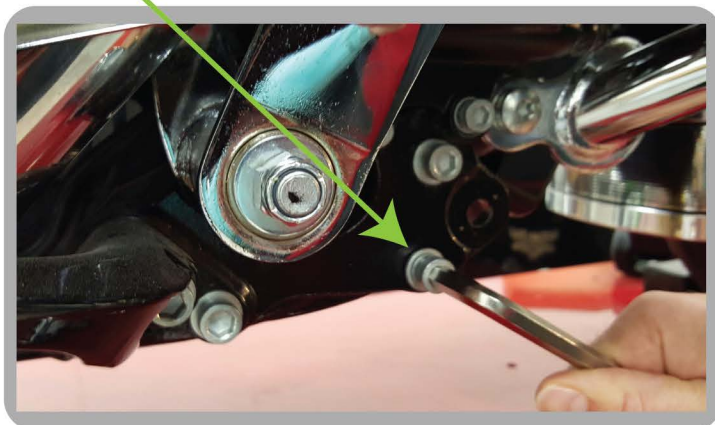

5. Put **Ciro** right mount in place and reinstall floorboard pivot pin and nut. Torque to 60-80 in-lbs.

WARNING:

This indication alerts you to the fact that ignoring the contents described herein can result in potential serious injury or death if not followed.

CAUTION:

This indication alerts you to the fact that ignoring the contents described herein can or will result in material damage and/or personal injury.

ATTENTION:

This indication alerts you to the fact if you ignore this detail you will affect the performance or functionality of the product.

All **Ciro** products are designed for "easy assembly" and/or "plug and play". We recommend a competent mechanic install our products, using standard mechanical procedures to assure a safe and successful installation.

NOTE:

Ciro products are designed and manufactured under very strict quality control. **Ciro** products are warranted to be free of defects in material and workmanship for 1 (one) year from date of purchase by the consumer.

Ciro will have no obligation if the customer cannot show proof of purchase.

Warranty will not be granted unless the part is properly installed and maintained.

Ciro will not be liable for any consequential and incidental damages, including labor, or non-**Ciro** products.

Please visit our website Ciro3d.com for our complete warranty policy.

CIRO3D.COM

6. Reinstall original 3/8"-16 x 2-1/2" SHCS and 3/8" nut into Giro right mount. Torque to 36-42 ft-lbs.

Note: For 2017 and newer models, reinstall original 3/8"-16 x 2-1/2" SHCS and thread into the tapped hole.

7. From Giro hardware kit, install 3/8"-16 x 1-3/8" SHCS with 3/8" flat washer and 3/8" split lock washer. Torque to 36-42 ft-lbs.



8. Assemble clevis and arm with 3/8"-24 x 7/8" SHCS and 3/8" high collar split lock washer. Leave fingertight.

9. Using a 5/16" hex wrench, install arm and clevis onto mount with 3/8"-24 x 1-1/8" SHCS. Torque to 36-42 ft-lbs.

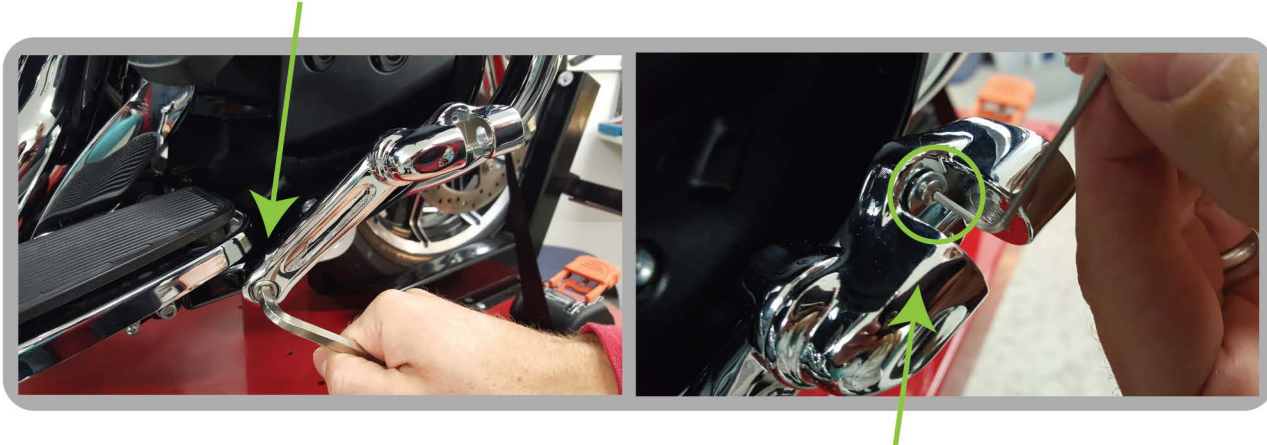

10. If using Giro Click Peg Mounts, install 4-40 x 3/8" BSHCS and tab spring with a 1/16" hex wrench. Install Giro footpeg with a D spring and 3/8"-24 x 1-1/8" SHCS.

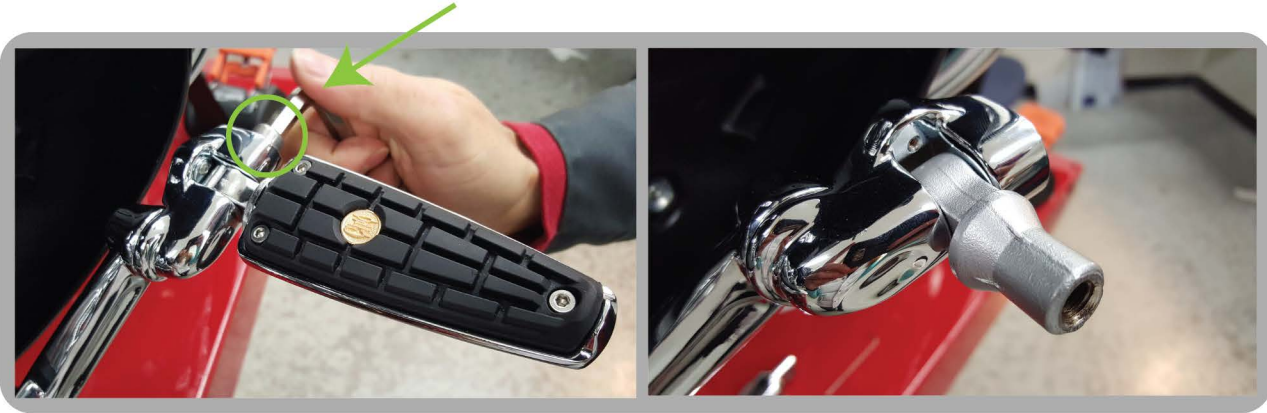

11. Use D spring and 3/8"-24 x 1-1/8" SHCS to install other footpegs. Torque to 25-35 ft-lbs.

12. Repeat steps 2 through 11 on left side.

13. Sit on motorcycle and adjust highway pegs to your liking. Check all clearances, including brake pedal and fairing lowers. Recheck all fasteners and tighten to recommended torque specifications.