



ZOMBIE WINDSHIELD TRIM 1198

FITS: '96-UP FLHT, FLHTC, FLHTCU, FLHX

PARTS INCLUDED

- 1 Zombie Windshield Trim
1 Hardware Kit Including:
2 1/4" Flat Washer
1 1/4"-20 x 5/8 Socket Button Head Cap Screw (SBHCS)
2 1/4"-20 x .625" Knurled Spike Fasteners
2 1/4"-20 x 1" Knurled Spike Fasteners
1 Zombie Emblem
1 Installation Instructions

Please read and understand entire instructions before starting installation.

THANK YOU FOR CHOOSING KÜRYAKYN!

IN ORDER TO PROTECT YOU AND OTHERS FROM POSSIBLE INJURY AND/OR PROPERTY DAMAGE OR LOSS, PLEASE PAY CLOSE ATTENTION TO ALL INSTRUCTIONS, WARNINGS, CAUTIONS AND ATTENTION NOTES REGARDING THE USE AND CARE OF THIS PRODUCT.

WARNING! THIS INDICATION ALERTS YOU TO THE FACT THAT IGNORING THE CONTENTS DESCRIBED HEREIN CAN RESULT IN POTENTIAL DEATH OR SERIOUS INJURY.

CAUTION! This indication alerts you to the fact that ignoring the contents described herein can result in potential injury or material damage.

ATTENTION! This indication alerts you to the fact that ignoring the contents described herein may negatively affect product performance and functionality.

TOOLS SUGGESTED

Set of hex wrenches, Torx wrenches, combination wrenches

STRICTLY OBSERVE THE FOLLOWING GUIDELINES IN ORDER TO USE THE PRODUCT PROPERLY AND AVOID POTENTIALLY DANGEROUS ACCIDENTS.

NOTE; IF INSTALLING WINDSHIELD TRIM ON KÜRYAKYN® AIRMASTER™ FAIRING, USE THE 1/4"-20 X 1" KNURLED SPIKE FASTENERS.

PROCEDURE

STEP 1 Park the motorcycle on a hard, level surface; turn off the ignition.

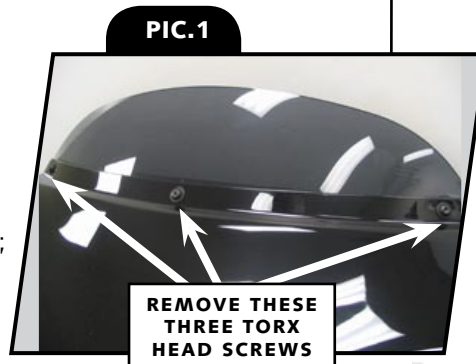

CUSTOMER SERVICE
877.370.3604 (toll free)

INSTALLATION QUESTIONS
techsupport@kuryakyn.com
or call 715.247.2983

LIMITED WARRANTY
Kuryakyn warrants that any Kuryakyn products sold hereunder, shall be free of defects in materials and workmanship for a period of one (1) year from the date of purchase by the consumer excepting the following provisions:

- Kuryakyn shall have no obligation in the event the customer is unable to provide a receipt showing the date the customer purchased the product(s).
• The product must be properly installed, maintained and operated under normal conditions.
• Kuryakyn makes no warranty, expressed or implied, with respect to any gold plated products.
• Kuryakyn shall not be liable for any consequential and incidental damages, including labor and paint, resulting from failure of a Kuryakyn product, failure to deliver, delay in delivery, delivery in non-conforming condition, or for any breach of contract or duty between Kuryakyn and a customer.
• Kuryakyn products are often intended for use in specific applications. Kuryakyn makes no warranty if a Kuryakyn product is used in applications other than intended.
• Kuryakyn electrical products are warranted for one (1) year from the date of purchase by the consumer. Components of Kuryakyn products containing L.E.D.s will be warranted for defects in materials and workmanship for 3 years from the date of purchase.
• Kuryakyn makes no warranty of any kind in regard to other manufacturer's products distributed by Kuryakyn. Kuryakyn will pass on all warranties made by the manufacturer and where possible, will expedite the claim on behalf of the customer, but ultimately, responsibility for disposition of the warranty claim lies with the manufacturer.

ABOUT OUR CATALOG
You'll find all our innovations for H-D, GL and Metric Cruisers in our annual catalogs. Order online today-select the "CATALOGS" icon. Each Kuryakyn® product comes with a Proof-of-Purchase good for a complimentary catalog. Details in packaging.

Be sure to ask your local dealer about other Kuryakyn products, the motorcycle parts and accessories designed for riders by riders.

©2005 Kuryakyn USA® All Rights reserved.



**STEP 2** Remove the three Torx head screws that secure the windshield shown in PIC.1. Set these aside, they will not be used again.

**STEP 3** Place the trim in place, lining up the holes in the trim with the holes in the in the windshield.

**STEP 4** Place the 1/4" - 20 x 5/8" SBHCS screw in the center hole without a washer, do not tighten.

**STEP 5** Place the appropriate Knurled Spike Fasteners in the outside holes with the 1/4" flat washers as shown in PIC.2, do not tighten.

**STEP 6** Tighten the screws, being careful not to over tighten them, which may damage the trim.

**STEP 7** Place the zombie emblem in place with head facing up as shown in PIC.3.

*Ride On!*

**PIC.2**



**PIC.3**

