



INSTALLATION INSTRUCTIONS

PART NUMBER: RK-3930

This Assembly Fits:

SEE CATALOG FOR CURRENT APPLICATIONS

SEE KNFILTERS.COM FOR CARB STATUS ON EACH PART FOR A SPECIFIC VEHICLE

Congratulations, you have purchased the finest custom air cleaner that money can buy. With proper care, this filter will last 1 million miles or more. This custom air cleaner replaces the stock air cleaner assembly. The following procedure **MUST** be followed to ensure a proper fit and seal of the custom air cleaner.

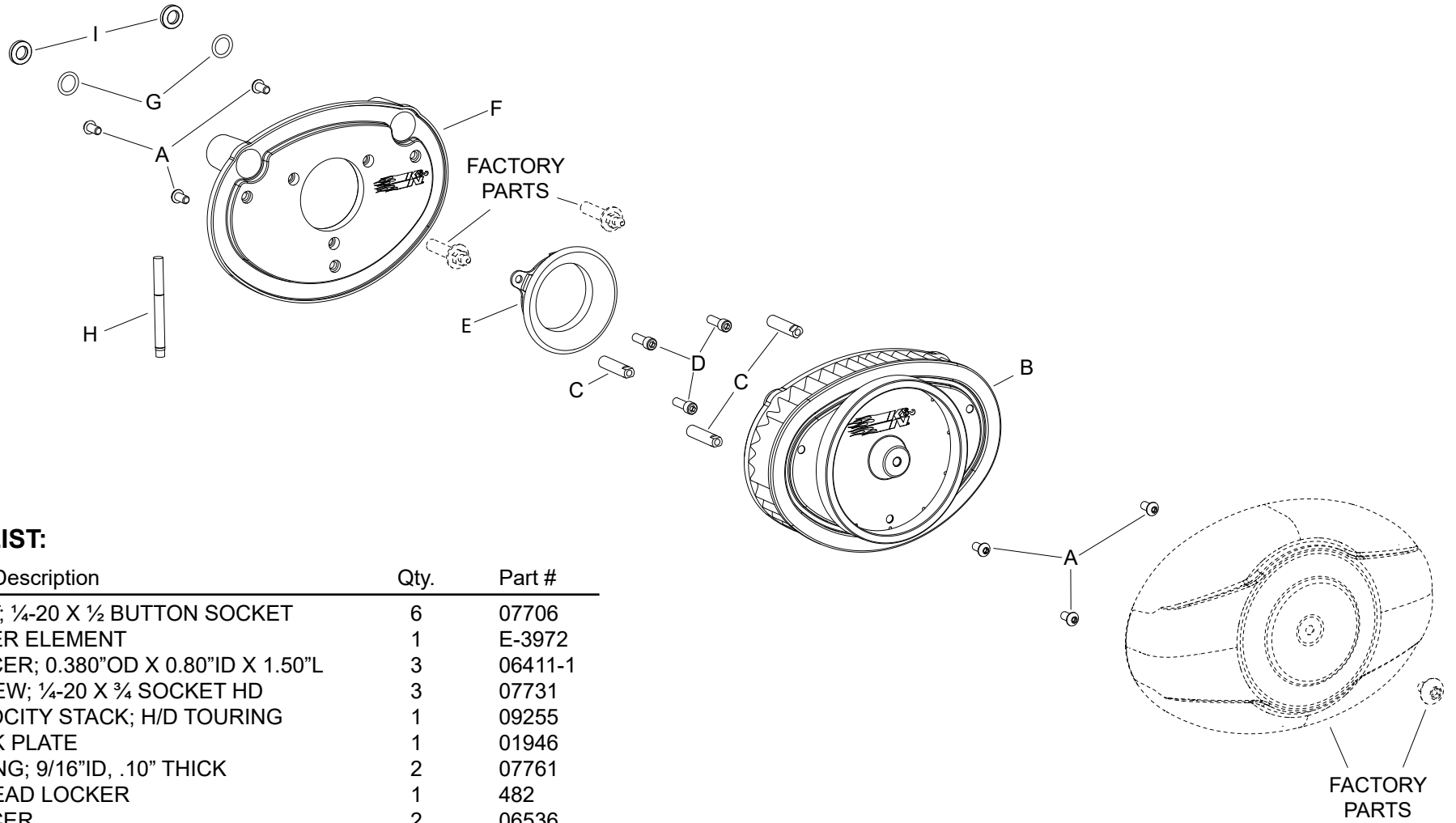

PARTS LIST:

Part Description	Qty.	Part #
A BOLT; 1/4-20 X 1/2 BUTTON SOCKET	6	07706
B FILTER ELEMENT	1	E-3972
C SPACER; 0.380"OD X 0.80"ID X 1.50"L	3	06411-1
D SCREW; 1/4-20 X 3/4 SOCKET HD	3	07731
E VELOCITY STACK; H/D TOURING	1	09255
F BACK PLATE	1	01946
G O-RING; 9/16"ID, .10" THICK	2	07761
H THREAD LOCKER	1	482
I SPACER	2	06536

If you need any assistance please call 1-800-858-3333 to speak with a representative in our Customer Service Center before returning the product.

NOTE: FAILURE TO FOLLOW INSTALLATION INSTRUCTIONS AND NOT USING THE PROVIDED HARDWARE MAY DAMAGE THE THROTTLE BODY AND ENGINE.

TO START:

1. Turn off the ignition and disconnect the negative battery cable.



2. Remove the bolt securing the air filter bonnet and then remove the bonnet from the vehicle.

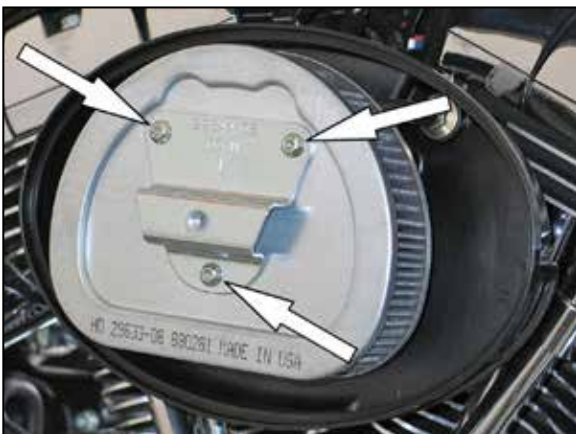

3. Remove the three bolts that secure the air filter and then remove the air filter and crank case breather tubes.



4. Remove the two crank case breather bolts securing the filter back plate and remove the back plate.



5. Install the provided intake venturi and three throttle body bolts into the K&N® back plate.



6. Install the three filter spacers onto the K&N® back plate using the provided hardware. **NOTE: Be sure to place one drop of thread locker onto each bolt.**



7. Install the filter back plate onto the throttle body and secure with the factory breather bolts and throttle body bolts provided. **NOTE: Be sure to install the two provided O-Rings into the receiver grooves on the back of the back plate.** **NOTE: On applications that have had the support bracket removed, install the two provided spacers between the back plate and cylinder head at the breather holes and then install the breather bolts as shown**



8. Install the K&N® air filter onto the back plate and secure with the provided hardware.

NOTE: Be sure to place one drop of thread locker onto each bolt.



9. Remove the factory bonnet gasket from the bonnet as shown.



10. Install the bonnet onto the K&N® air filter and secure with the factory bolt.

12. Double check to make sure everything is tight and properly positioned before starting the vehicle.

13. It will be necessary for all K&N® high flow intake systems to be checked periodically for realignment, clearance and tightening of all connections. Failure to follow the above instructions or proper maintenance may void warranty.

ROAD TESTING:

1. Start the engine with the transmission in neutral or park. Listen for air leaks or odd noises. For air leaks secure hoses and connections. For odd noises, find cause and repair before proceeding. This kit will function identically to the factory system except for being louder and much more responsive.

2. Test drive the vehicle. Listen for odd noises or rattles and fix as necessary.

3. If road test is fine, you can now enjoy the added power and performance from your kit.

4. K&N Engineering, Inc., suggests checking the air filter element periodically for excessive dirt build-up. When the element becomes covered in dirt (or once a year), service it according to the instructions on the Recharger® service kit, part number 99-5050 or 99-5000.

NOT LEGAL FOR SALE OR USE ON ANY POLLUTION CONTROLLED MOTOR VEHICLE IN CALIFORNIA OR STATES ADOPTING CALIFORNIA EMISSION PROCEDURES.

See knfilters.com for CARB status on each part for a specific vehicle